

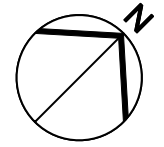

# Brown County Courthouse

100 S Jefferson Street, Green Bay, WI 54301

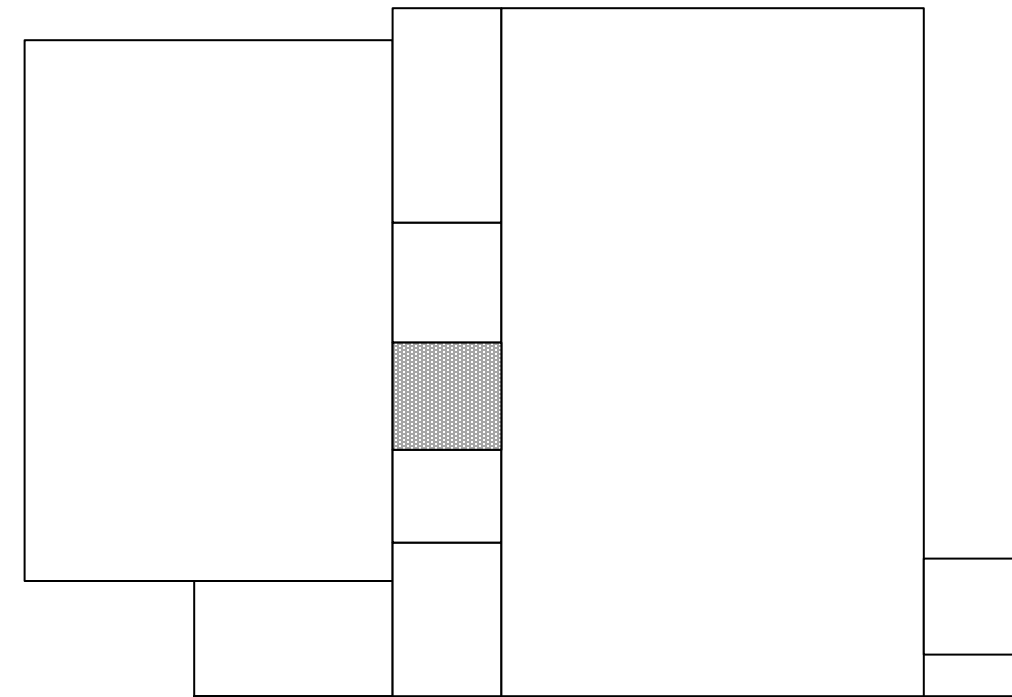
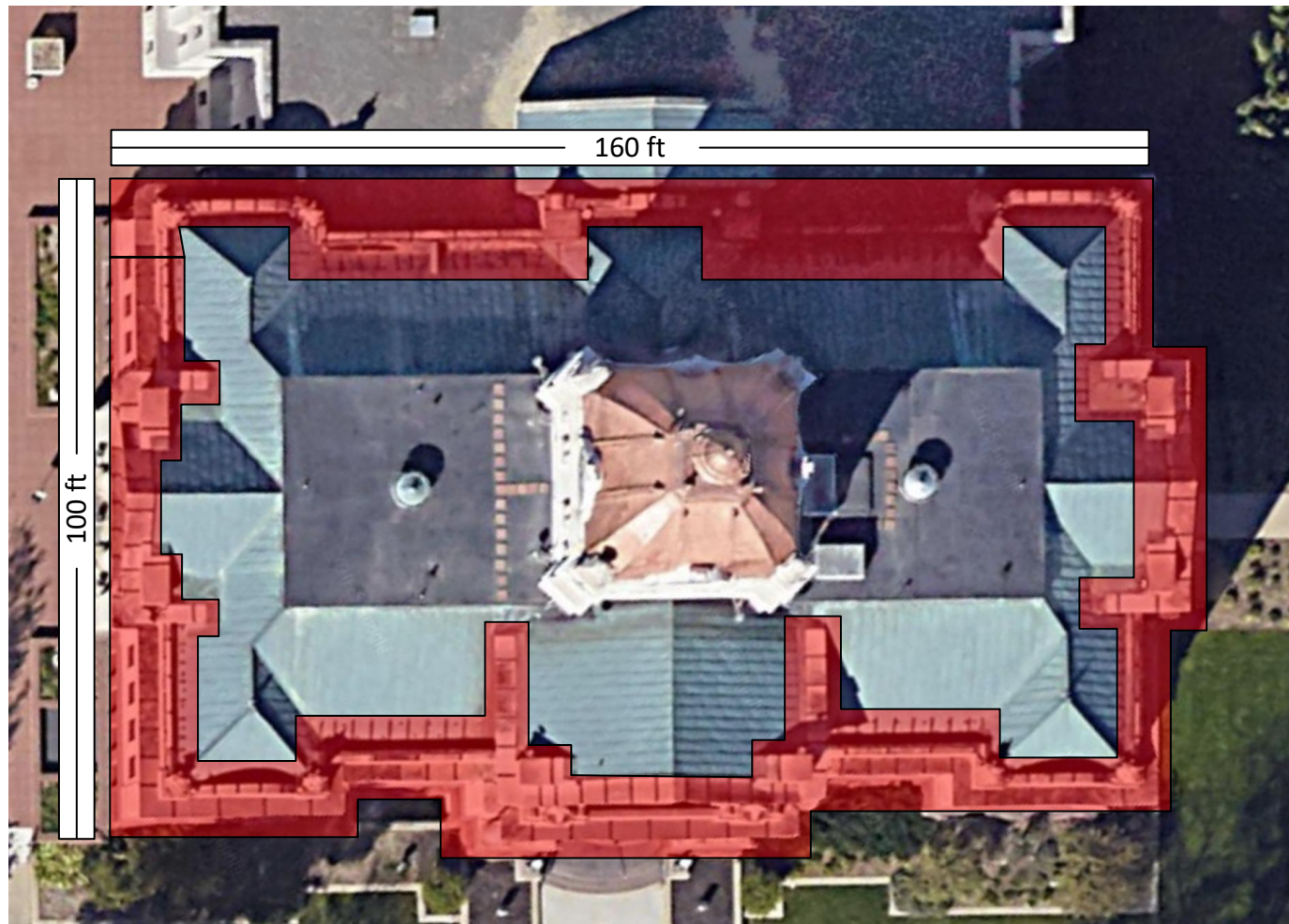

The Garland Company  
3800 E. 91<sup>st</sup> Street  
Cleveland, OH 44105

THE INFORMATION CONTAINED HEREIN IS OF A PROPRIETARY NATURE AND IS SUBMITTED IN CONFIDENCE FOR USE BY THE CLIENTS APPROVED BY THE ORIGINATOR OF THIS DOCUMENT - ONLY. THE USE OF THESE DOCUMENTS FOR ANY OTHER PROJECTS, PURPOSE, LOCATION, PUBLICATION, REPRODUCTION OR DISTRIBUTION IN WHOLE OR PART, BY ANY INDIVIDUAL OR ORGANIZATION WITHOUT WRITTEN PERMISSION THE ORIGINATING COMPANY IS PROHIBITED. THE INFORMATION HEREIN REMAINS THE PROPERTY AND ITS USE OR DISCLOSURE TO OTHERS IS PROHIBITED FOR ANY USE NOT AUTHORIZED BY THE ORIGINATING COMPANY.

Dimensions To Be Verified

Brown County Courthouse  
100 S Jefferson St  
Green Bay, WI 54301

SHEET TITLE:

COVER PAGE

SHEET NO.

A-1

— Repair Location

A-1: Cover Page  
A-2: Scope of Work

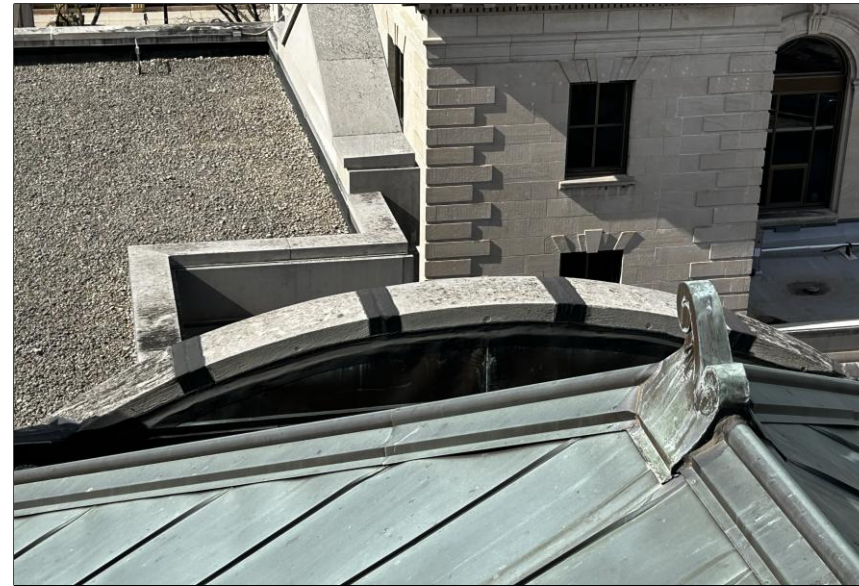

The Garland Company  
3800 E. 91<sup>st</sup> Street  
Cleveland, OH 44105

THE INFORMATION CONTAINED HEREIN IS OF A PROPRIETARY NATURE AND IS SUBMITTED IN CONFIDENCE FOR USE BY THE CLIENTS APPROVED BY THE ORIGINATOR OF THIS DOCUMENT - ONLY. THE USE OF THESE DOCUMENTS FOR ANY OTHER PROJECTS, PURPOSE, LOCATION, PUBLICATION, REPRODUCTION OR DISTRIBUTION IN WHOLE OR PART, BY ANY INDIVIDUAL OR ORGANIZATION WITHOUT WRITTEN PERMISSION THE ORIGINATING COMPANY IS PROHIBITED. THE INFORMATION HEREIN REMAINS THE PROPERTY AND ITS USE OR DISCLOSURE TO OTHERS IS PROHIBITED FOR ANY USE NOT AUTHORIZED BY THE ORIGINATING COMPANY.

Dimensions To Be Verified

Brown County Courthouse  
100 S Jefferson St  
Green Bay, WI 54301

**Scope of Work – Brown County Courthouse**

- Remove all dirt or debris from open and loose areas of EPDM coverstrip.
- Remove any failed or cracked sealant.
- Apply structural sealant around all edges of coverstrip.
- For any areas of coverstrip that have failed: remove existing coverstrip, apply single ply primer, replace coverstrip, and apply structural sealant around all edges.

**Sealant Specification Requirements:**

- Service Temp -40°F to 200°F (-40°C to 93°C)
- Elongation, ASTM D 412: 550%
- Hardness, Shore A, ASTM C 661: 24 +/-3
- Viscosity at 70 F (20°C) - 812,500+ cPs
- No measurable shrinkage after 14 days
- Single component 100% solids polyether sealant

SHEET TITLE:

Scope Of Work

SHEET NO.

A-2